

# Power Generator & Wildfire Predictor

## Problems encountered

"Wild elephants" have been encroaching on villagers' farming areas for a long time and "forest fires" that occur regularly every year. Until a large amount of forest area was destroyed.

## Solution

Invented Power Generator and Wildfire Predictor for Wildlife tracker collar.

## Power Generator system design

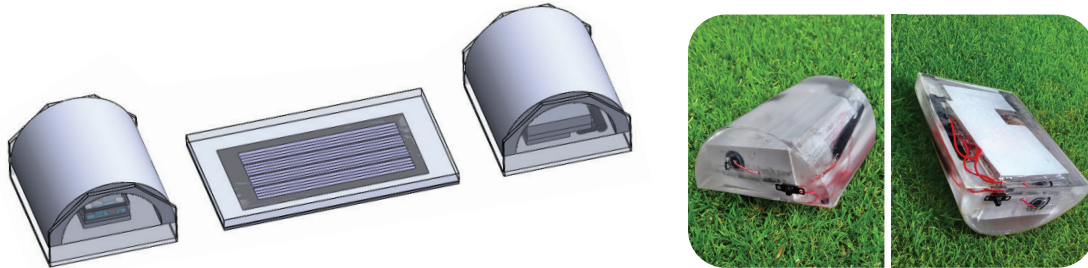

From the picture above, it is a design of a device that will be installed on an elephant's neck or Collar, which is already in general use. The additional equipment installed will have 2 parts as follows:

1. Flexible solar cell panels. (center in the picture) which is difficult to break Its role is to produce electrical energy from sunlight. It will be cast in clear resin to cover the container. into the metal tarp to prevent shock.
2. Power Generator Module, Generator power from kinetic energy, Flexible solar panels and Piezo sensors (Pressure sensor) and storage power. The Module coated with resin high pressure and cover with strong polymer before attaching to the metal bracket.

For the right hand rod module of the figure can be adjusted Between the elephant tracking device using the GPS system or a sensor module that prediction forest fires.

## Collar that is actually used

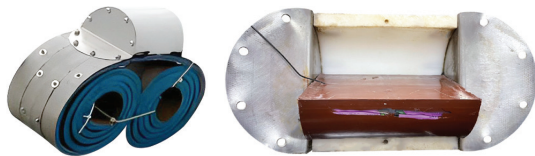

## Approximate size

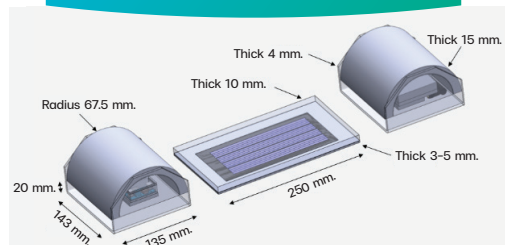

## electronic equipment

Charging and power supply control circuit

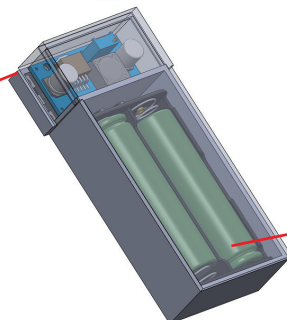

Battery

Consists of 2 parts: a battery and a charging control circuit or power supply to the prototype device.

## Contact us

✉ [thanadolwang@gmail.com](mailto:thanadolwang@gmail.com)

🌐 [www.thanadolwangwijit.com](http://www.thanadolwangwijit.com)